

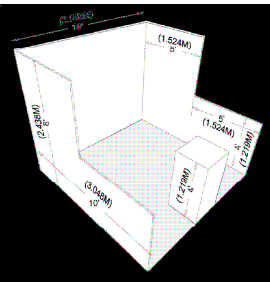

BOOTH STRUCTURES

- Linear:** 10ft x 10ft minimum or multiples there of (10ft x 20ft, 10ft x 30ft, etc.)
- Peninsula:** 20ft x 20ft minimum, with three open sides. Will only accommodate a 10ft wide back wall.
- Island:** 20ft x 20ft minimum, four open sides.
- Split Island:** 10ft x 20ft minimum, three open sides, and one common backwall.
- Mobile Unit Structure or Vehicle:** 10ft x 20ft minimum.
- Hard Wall Pavilion Booth:** A single location with hard walls extending to the outer edge of three sides that includes carpet flooring and a limited amount of furniture.
- Shell Scheme Booth:** A Linear booth that is a complete turnkey package consisting of furniture, flooring, lighting, lead retrieval, electricity and warehouse freight handling.



Linear Booths have only one side exposed to an aisle and are arranged in a series along a straight line. They are also called "in-line" booths.

Dimensions: For consistency linear booths are arranged in draped increments of 10 ft. The de facto standard in the United States and FIME, booths are 10 ft. wide and 10ft deep in increments of 10ft.

Use of Space: Regardless of the number of Linear Booths utilized, e.g. 10ft by 20ft, 10ft by 30ft, 10ft by 40ft, etc. display materials must be arranged in such a manner as not to obstruct sight lines of neighboring exhibitors. The maximum height of 8ft is allowed only in the rear half of the booth space, with a 4ft height restriction imposed on all materials in the remaining space forward to the aisle. When three or more Linear Booths are used in combination as a single exhibit space, the 4ft height limitation is applied only to that portion of exhibit space, which is within 10ft of an adjoining booth.

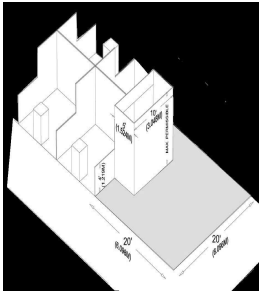

Peninsula Booth is a booth exposed to the aisle on three sides that backs up to linear booths. They are also called end cap booths.

Dimensions: A Peninsula Booth is 20ft x 20ft or larger.

Use of Space: The backwall is restricted to 4ft high within 5ft of each aisle, permitting adequate line of sight for the adjoining Linear Booth 16ft is the maximum height allowance, including signage for the center portion of the backwall.

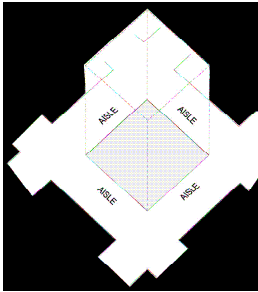

An **Island Booth** is exposed to aisle on all four sides.

Dimensions: An Island Booth is 20ft x 20ft or larger.

Use of Space: The entire cubic content of the space may be used up to the maximum allowable height of 16ft including signage.

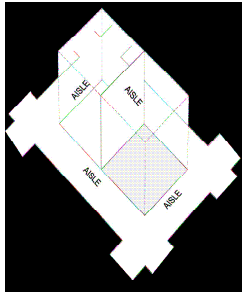

A **Split Island Booth** is exposed to the aisle on three sides.

Dimensions: A Split Island Booth is 10ft x 20ft or larger.

Use of Space: The entire cubic content of the space may be used up to the maximum allowable height of 16ft including signage.